

# OST / OLTS



## General Purpose Jacks - Threaded Ram With Safety Lock Nut, Single Acting, Spring / Load Return

Capacity 10 - 2000 ton / Stroke 150 mm / Max. Working Pressure 700 bar



OST Series



OSTS / OLTS Series



### Features / Application

- Standard multipurpose application jacks
- Spring return mechanism upto 500t capacity, Load return for 600t and above
- Spherical saddle for 500t and above; optional for lower capacities
- Ideally suited for application requiring sustained load holding in Infrastructure projects, heavy industries

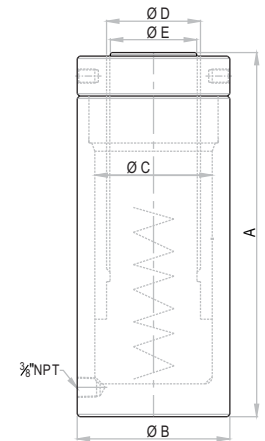

**OST Series** - **O** Orione **S** Single acting Spring return **T** Threaded ram **10** Capacity - ton **150** Stroke - mm

**OSTS Series** - **S** Spherical saddle (Tilting angle 5° Max.)

Capacity (ton)	Capacity (kN)	Stroke (mm)	Model with Plain saddle	Model with Spherical saddle	Effective area (cm <sup>2</sup> )	Oil cap. (cc)	Closed height (Plain saddle) A (mm)	Closed height (Spherical saddle) A (mm)	Cylinder OD B (mm)	Bore dia. C (mm)	Ram dia. D (mm)	Plain saddle dia. E (mm)	Spherical saddle dia. E (mm)	Wt. (Approx.) (Plain saddle) (kg)	Wt. (Approx.) (Sph. saddle) (kg)
10	111	150	OST 10-150	OSTS 10-150	15.9	239	245	255	60	45	40	34	35	4.5	4.7
15	167	150	OST 15-150	OSTS 15-150	23.8	356	250	265	70	55	50	43	43	6.5	6.7
20	218	150	OST 20-150	OSTS 20-150	31.2	468	260	275	80	63	55	48	48	9	9.3
25	270	150	OST 25-150	OSTS-25-150	38.5	577	270	285	90	70	55	50	48	11.3	11.7
30	309	150	OST 30-150	OSTS 30-150	44.2	663	275	290	100	75	60	55	55	14.5	15
50	550	150	OST 50-150	OSTS 50-150	78.5	1178	290	305	130	100	80	75	74	26.5	27
75	792	150	OST 75-150	OSTS 75-150	113.1	1696	295	320	155	120	95	89	88	37	38
100	1077	150	OST 100-150	OSTS 100-150	153.9	2309	305	325	180	140	110	103	100	56	57
150	1589	150	OST 150-150	OSTS 150-150	227.0	3405	325	350	220	170	140	133	130	86	88.5
200	2199	150	OST 200-150	OSTS 200-150	314.2	4712	340	365	255	200	160	152	150	110	114
250	2661	150	OST 250-150	OSTS 250-150	380.1	5702	350	385	280	220	180	170	165	134	139
300	3167	150	OST 300-150	OSTS 300-150	452.4	6786	370	405	310	240	200	192	180	176	183.5
400	4008	150	OST 400-150	OSTS 400-150	572.6	8588	405	445	350	270	220	212	212	240	252
500	4948	150	-	OSTS 500-150	706.9	10603	-	465	400	300	250	-	230	-	363

**OLTS Series** - **O** Orione **L** Single acting Load return **T** Threaded ram **S** Spherical saddle (Tilting angle 5° Max.) **600** Capacity - ton **150** Stroke - mm

Capacity (ton)	Capacity (kN)	Stroke (mm)	Model	Effective area (cm <sup>2</sup> )	Oil cap. (cc)	Closed height A (mm)	Cylinder OD B (mm)	Bore dia. C (mm)	Ram dia. D (mm)	Saddle dia. E (mm)	Wt. (Approx.) (kg)
600	5987	150	OLTS 600-150	855.3	12829	495	430	330	275	260	495
800	7939	150	OLTS 800-150	1134.1	17012	535	505	380	310	290	731
1000	9930	150	OLTS 1000-150	1418.6	21279	570	560	425	350	330	970
1500	15154	150	OLTS 1500-150	2164.8	32472	660	705	525	450	400	1822
2000	20458	150	OLTS 2000-150	2922.5	43837	750	810	610	525	495	2688

■ Higher capacity and customized solutions on request. ■ Specifications are subject to change due to continual improvement.

■ Capacity and Stroke specified are maximum safe limits. As safe practice, use at 80% of rating.

### CUSTOMISED SOLUTIONS

